

MARLBOROUGH STREET

LYONS ROAD

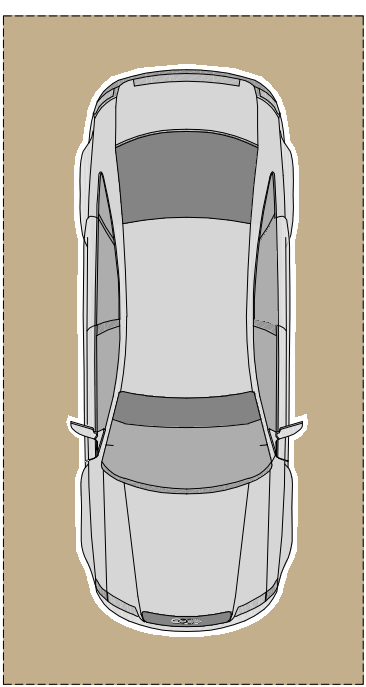
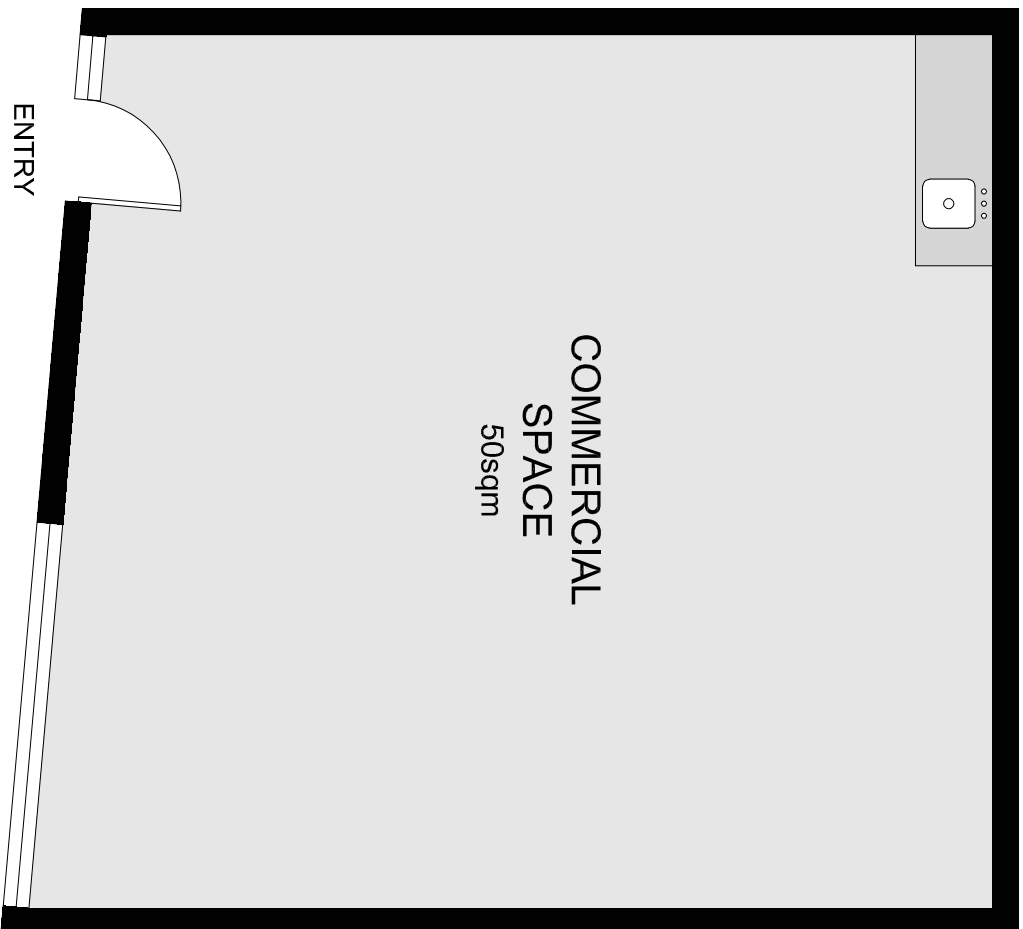

SECURITY PARKING

Approximate Areas:

Internal:	50m <sup>2</sup>
Car space:	14m <sup>2</sup>
Total:	64m <sup>2</sup>



**DRUMMOYNE**  
**10/52 Lyons Road**  
rogermickhail.com.au / 02-9713-5900

